



**EN      Installation Manual  
Decentralised Ventilation System  
with Heat Recovery  
Series e<sup>2</sup>**

- Please pass on to user -

## Contents

## Page:

About this manual, Safety instructions, Technical specifications, Disposal	10
Dimension diagrams, Installation position	11
Operating range, Shipping units	12
Assembly: Assembly pipe and Outer grille	13
Assembly: Electric installation and Electric connection	14
Assembly: Heat recovery unit and Inner screen	14
Assembly: Sound insulation set	15
Filter replacement, Cleaning, Note on LUNOS Outer covers	16
Additional parts and Replacement parts	16

## About this manual

- Read this manual carefully and completely before assembly. Always observe the general safety instructions and the safety symbols with information in the text.
- Hand out this manual to the user (tenants, proprietors, property management etc.) after completing assembly.

## Symbols in this manual



This symbol warns you against risks of injury



This symbol warns you against risks of injury from electricity

## Safety instructions



**Caution!** Any assembly work to the ventilation device may only be carried out after disconnecting all poles of the supply voltage. The ventilation device is fitted with protective insulation according to Protection Class II, a protective conductor connection is not required.



**Attention!** The electric connection may only be made by authorised qualified personnel and according to the applicable version of VDE 0100.



**Attention!** This device must not be operated by children and persons (filter replacement/cleaning) who are not able to operate the device safely due to their physical, sensory or mental abilities or their inexperience or lack of knowledge. Children should be supervised to ensure that they do not play with the device.

## Technical specifications

	e <sup>2</sup> , e <sup>2</sup> short	e <sup>2</sup> 60, e <sup>2</sup> 60short
Device voltage	12 V DC SELV	12 V DC SELV
Type of protection	IP 22	IP 22
Volume flow	18m <sup>3</sup> /h at 38 m <sup>3</sup> /h	18m <sup>3</sup> /h at 60 m <sup>3</sup> /h
sound power level	40 dB (A)	42 dB (A)

## Disposal



The packaging must be sorted before disposal. If you wish to dispose of the ventilation device, observe the current regulations. The competent municipal authority will provide information.

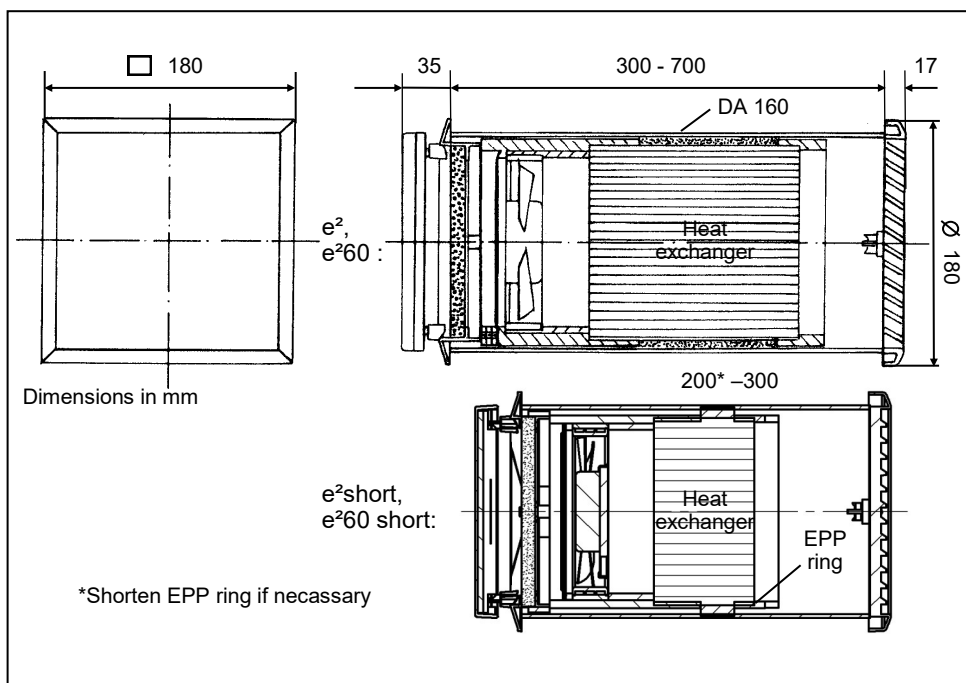

### Installation position

Decentralised ventilation devices with heat recovery of the type  $e^2$  only function in pairs in bidirectional operation. One device operates 70 s (50 s for  $e^2$  short) in supply air operation, the other 70 s (50 s for  $e^2$  short) in exhaust air operation at the corresponding airflow level as set. Then the air direction is changed. It is thus ensured that the total of the airflow volume supplied is equal to the total exhaust airflow volume. If a device pair operating in push-pull operation is installed and operated in two different rooms of the flat, a sufficiently dimensioned interconnection between the air movement must be provided by excess flow air vents.

Recommended minimum spacing when installing a pair of devices in a wall:

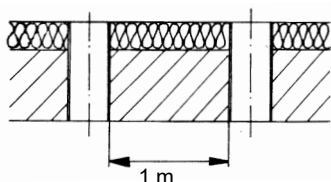

Recommended minimum spacing when installing a pair of devices across a corner:

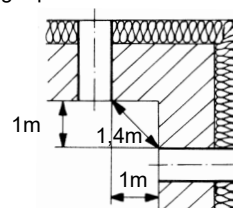

Do not place the devices above sensitive pieces of furniture, surfaces or pictures. The wall underneath the devices should be left "free".  
Do not place the devices above or near room thermostats.

## Operating range

EN

Temperature range: -15°C to +40°C

Usable with relative humidity levels of up to 65% in the interior area (not condensing). When usage limits are exceeded, switch off the device and close the inner screen. Ensure fresh air supply by window ventilation.

## Shipping units

**Check the supplies for completeness and mint condition!**

### Assembly pipe

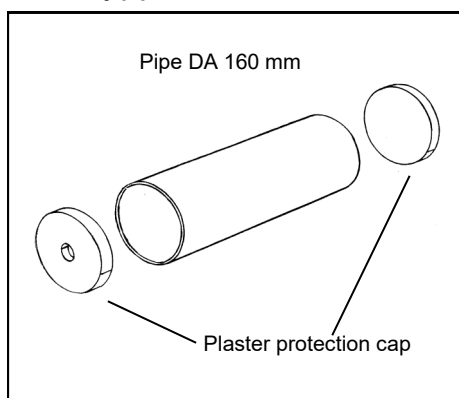

### Outer grille

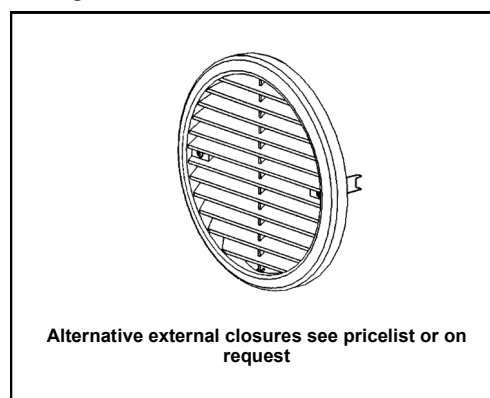

### Insert e<sup>2</sup>

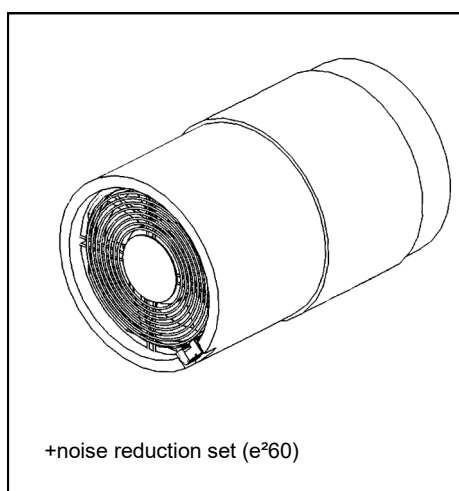

### Inner screen

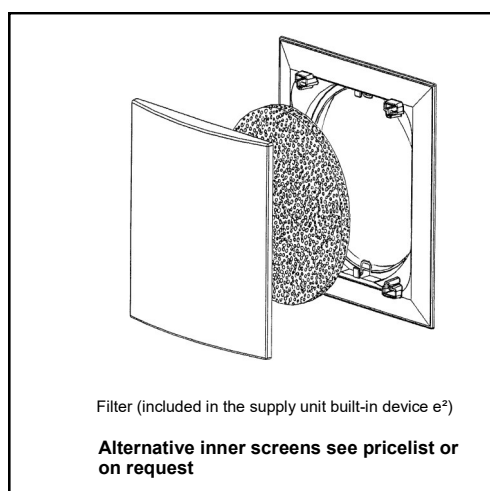

The outer grilles with a diameter of 180 mm are supplied together with the facade protection ring. A corresponding installation manual is enclosed.

Make the wall openings for the assembly pipes (e.g. by coring, core bit Ø 162 mm).  
If necessary shorten the pipe to the required installation length (e<sup>2</sup>: min. 300 mm; e<sup>2</sup>short: min. 200 mm).  
Take care that the pipe overlaps on both sides to cope with the plaster thicknesses (after plastering the pipe must close flush with the plaster). Insert the pipe and seal it all around. (Assembly glue Order No. 038 733).

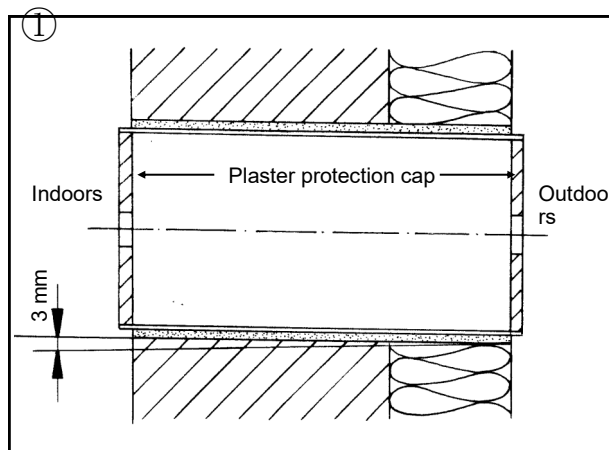



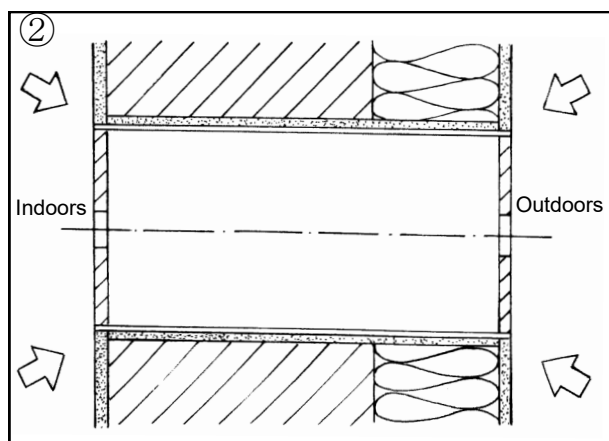

Apply plaster indoors and outdoors. If outer closure is plastered, first replace the plaster protection cap outdoors by an outdoor closure piece.

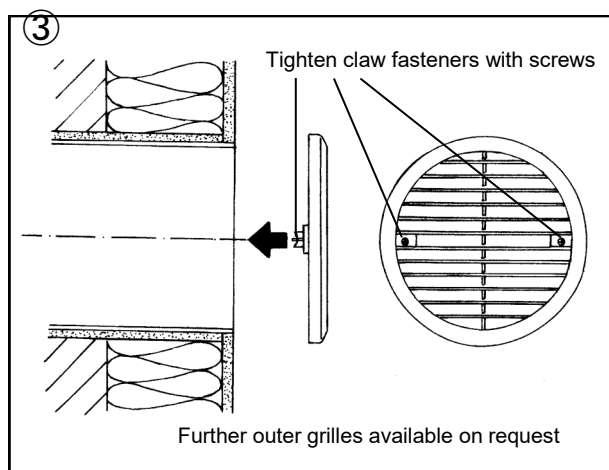

Remove the plaster protection cap outdoors. Assemble the outer grille using the integrated claw fasteners (tighten screws).



**Safety instructions:**

-  Caution! Any assembly work to the ventilation device may only be carried out when all poles of the supply voltage have been disconnected.
-  Make sure that the supply voltage of all connection lines is voltage-free (dead). (Separation from the power supply with a minimum contact opening of 3 mm, e.g. electric fuse disconnecting all poles).
-  Each electric circuit of this ventilation system must be fitted with a residual current protection (e.g. FI switch/RCCB).
-  Electric connection only by a specialist. Additional installations and electrical components in this ventilation system are not allowed.

The system can be controlled via several controls of LUNOS.

**Follow the relevant installation instructions.**

Select the position of the switch. Slit the cable ducts (power cable + cable to the device pairs) and the pipes (2 cm deep). Lay the power cable (e.g. 3 x 1.5 mm<sup>2</sup>) and the cables to the pairs of devices (e.g. 3 x 0.75 mm<sup>2</sup>). Place the cables to the device pairs ready in the pipes.

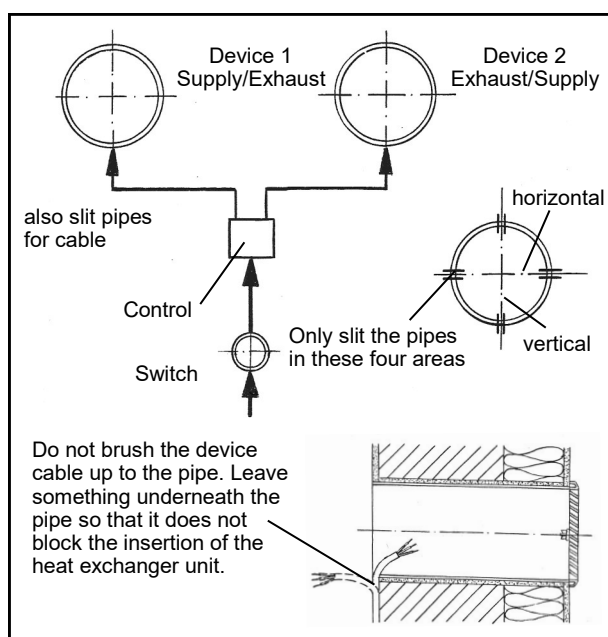

**Assembly: Heat recovery unit and Inner screen**

Remove plaster protection cap inside, insert heat exchanger unit into the assembly pipe, ensure there is a 22 mm spacing. Motor is on the inside. Using the loop on the inside of the heat exchanger unit the said unit may be pulled out for correction purposes.

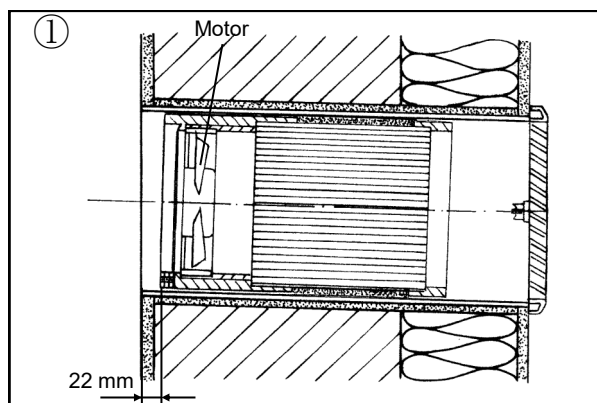

## Assembly: Heat recovery unit and Inner screen

EN

Connect cables to plugs, insert pin and socket connectors into the recess of the heat exchanger casing.

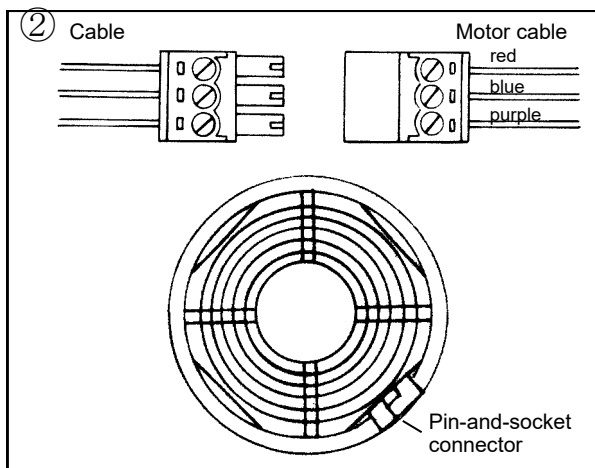

Insert inner closure with filter casing, snap the indoor screen into place in open position. Ready.

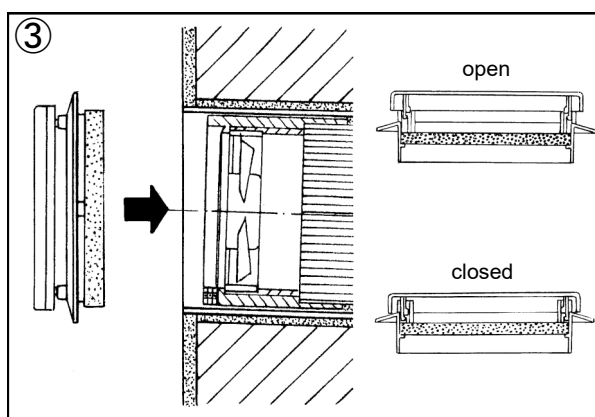

## Assembly: Sound insulation set

EN

The sound insulation inserts are supplied as mats, has to be inserted in a ring shape in the pipe and positioned as shown. For a maximum effect, the tube should be completely filled between the device and the inner screen. If necessary, shorten the ring (s).

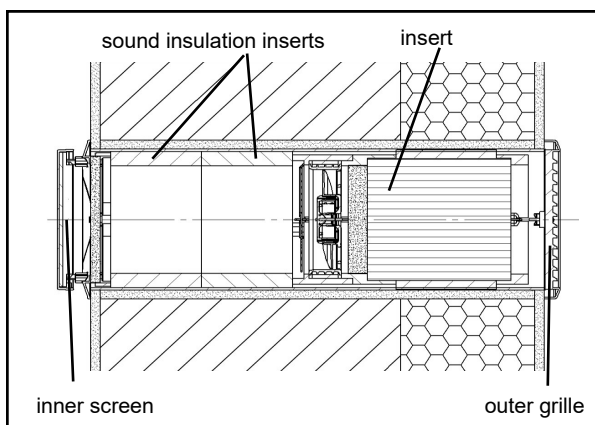

## Filter replacement

EN

The filter replacement indicator signals that a filter is contaminated. In what way this is done, please refer to the description of the control device.

Remove front cover, take filter out, insert new or cleaned filter (filters can be cleaned e.g. in a dishwasher), put front cover on. The ventilation openings must not be blocked or covered.

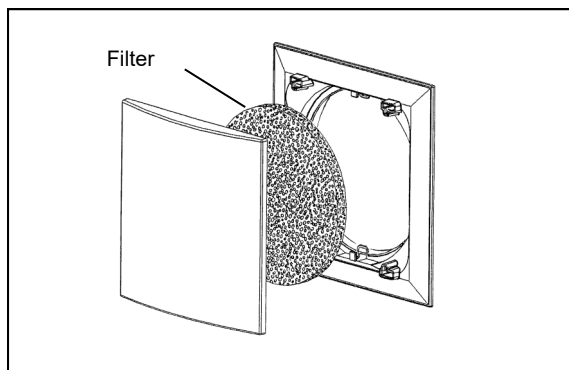

Please note below information on the filter changes you have carried out:

Filter replacement date	Expected filter replacement	Type of filter used

## Cleaning

If necessary wipe the indoor screen and covering frame with a dry soft cloth.

 Filter replacement and cleaning must not be carried out by children or by persons who are not able to operate the device safely due to their physical, sensory or mental abilities or their inexperience or lack of knowledge.

## Note on LUNOS outer covers

The full-plastic outer covers supplied by LUNOS provide high resistance to driving rain and meet the requirements of Stress Group III according to DIN 4108-3 (2014-11). Metallic or metal-coated covers can be used in Stress Group I in accordance with DIN 4108-3 (2014-11).

For buildings in wind-exposed locations or if there is a risk of strong winds and rain on the outer covers, additional weather protection measures must be taken, if necessary.

## Additional parts and replacement parts

Indoor screen compl. 9/IBE  
Replacement filter G3, 9/FIB3R, three-pack  
Sound insulation set 9/SW  
Wind pressure relief 9/WDSE (for assembly pipes from 370 mm length)  
Sound protection screen 9/IBS

Order No.: 39 851  
Order No.: 37 214  
Order No.: 39 850  
Order No.: 39 860  
Order No.: 39 947



**Partel Ireland**  
**Website:** [www.partel.ie](http://www.partel.ie)  
**Email:** [sales@partel.ie](mailto:sales@partel.ie)  
**Phone:** 0818333355

**Partel UK**  
**Website:** [www.partel.co.uk](http://www.partel.co.uk)  
**Email:** [sales@partel.co.uk](mailto:sales@partel.co.uk)  
**Phone:** 02037401918