



SUSTAINABILITY THROUGH TECHNOLOGY

AIR & WINDTIGHT SYSTEMS



Next generation monolithic technology

- Wind proof, diffusion open
- Available with integrated tapes on both sides

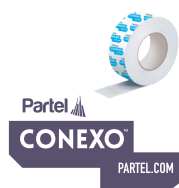

Interior and exterior airtight tape

- Reinforced with elasticity
- Split release backing
- For window intalation (SL version)



Moisture Variable airtight membrane

- Variable range ensures optimum drying conditions
- Reinforced for optimum strenght



Optimum airtight and vapour control membrane

- High performance airtightness
- Reinforced for optimum strenght



Nail sealing tape to seal between battens and ExoPerm

- Prevents water ingress



Next generation monolithic technology

- Long term resistance to driving rain
- Wind proof but diffusion open



Water and airtight connection

- Easy to install
- Elastic and durable



Multipurpose airtight adhesive

- Solvent free
- Durable and flexible



Primer for porous surfaces

- Quick drying
- Workable on cold surfaces



Interior window installation tape

- High performance airtight tape
- Split release backing



Patch tape for blown fibre insulation

- High performance airtight tape
- Stable with Acrylic adhesive



Assists with pressure application of tapes

Assists with pressure application of tapes

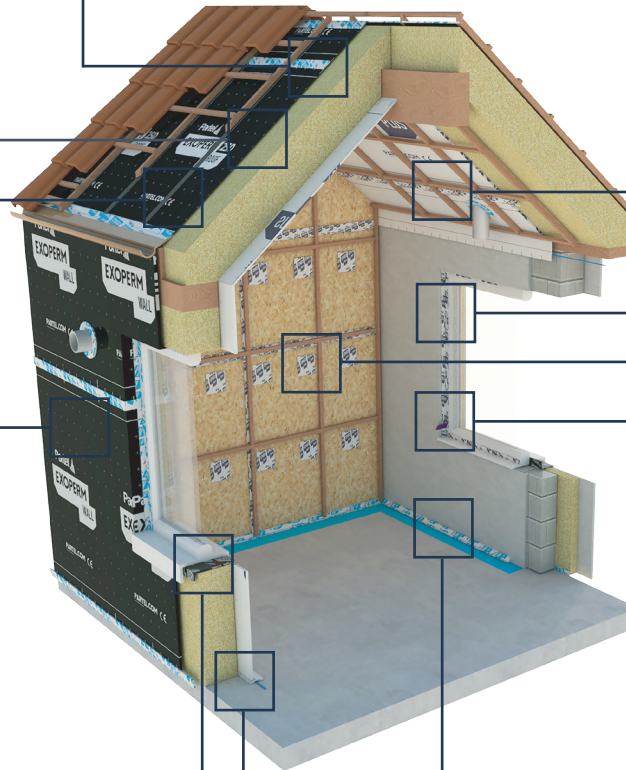

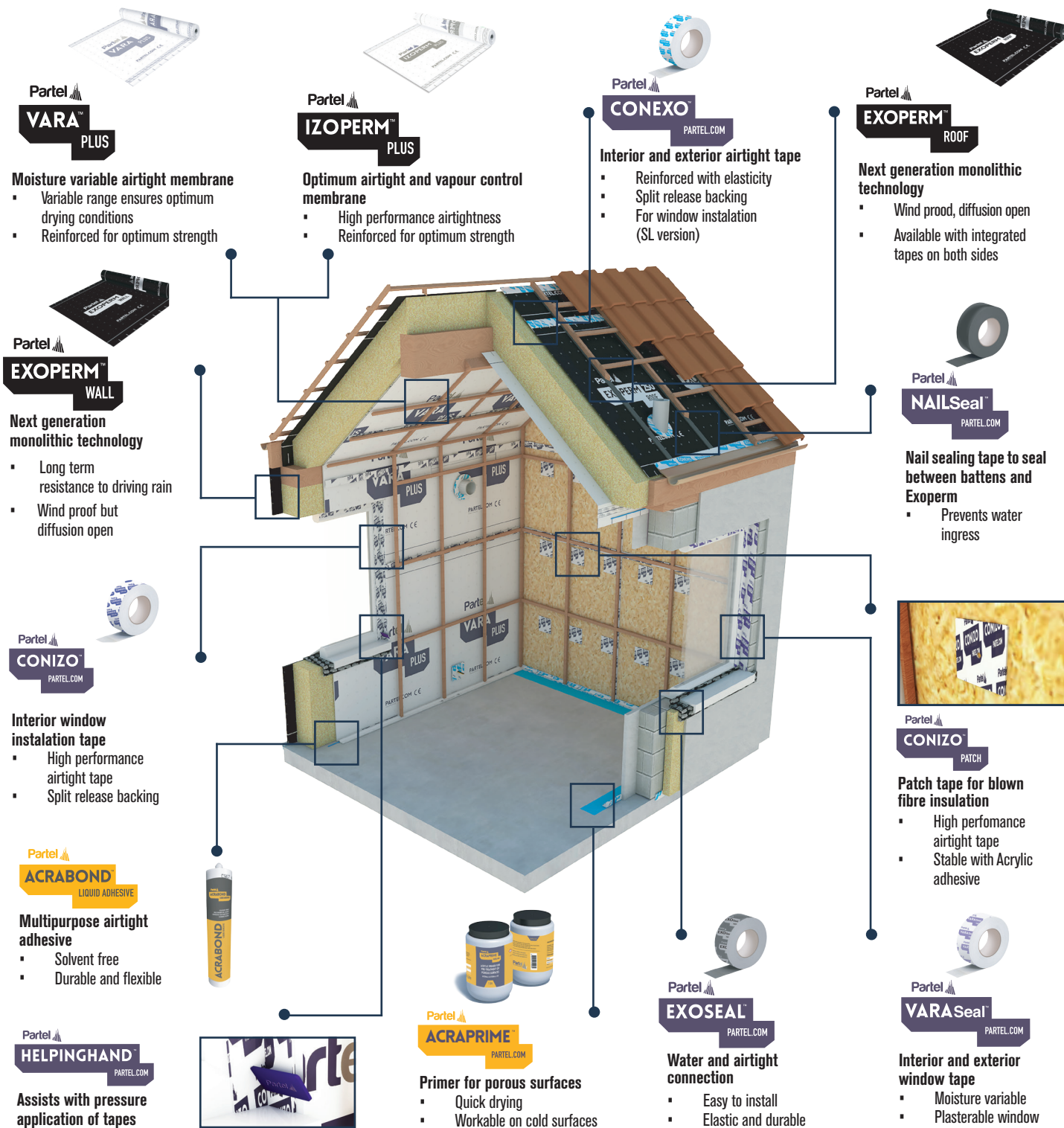

Partel

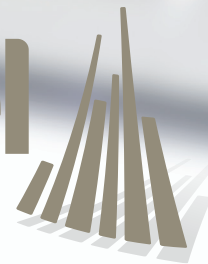

PARTEL TECHNICAL SERVICE

- Free WUFI condensation risk analysis
- Technical advice
- Specification assistance
- Detailed working drawings
- Installation/application training



WWW.PARTEL.COM
SALES@PARTEL.COM
 TEL: 888 487 1012



WWW.PARTEL.CO.UK
SALES@PARTEL.CO.UK
 TEL: 02037 401918



WWW.PARTEL.IE
SALES@PARTEL.IE
 TEL: 0818 33 33 55

